

How to setup Boundary-Crossing detection recording?

Step 1: Connect the power of the camera.

Step 2: Open **Mydlink** Apps on the mobile device.



Step 3: Enter the register Mydlink **Username and password.**

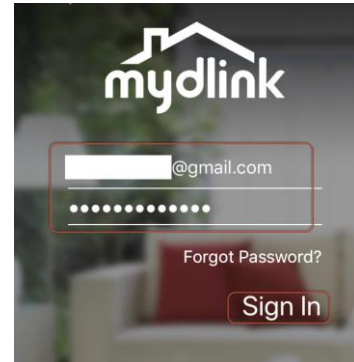

Step 4: Click on the **Menu** Icon.

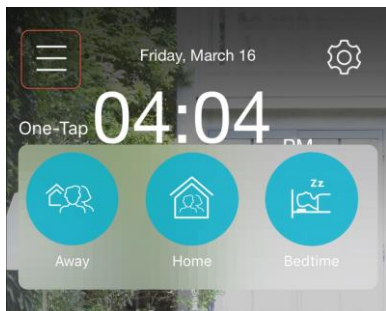

Step 5: Click on **Devices**

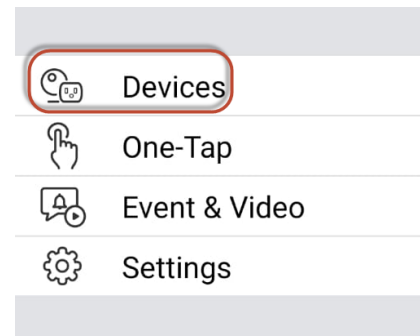

Step 6: Click on **Camera**.

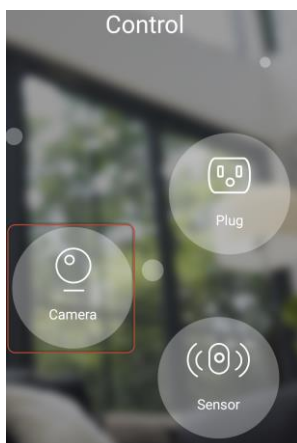

Step 7: Click on **Setting** Icon.

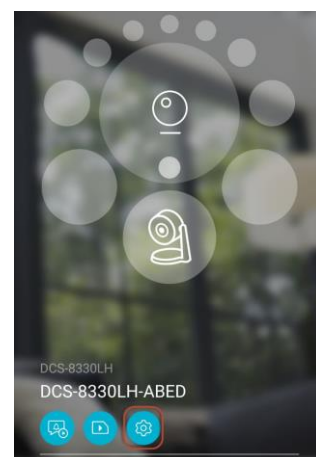

Step 8: Click on Moving Object Detection.

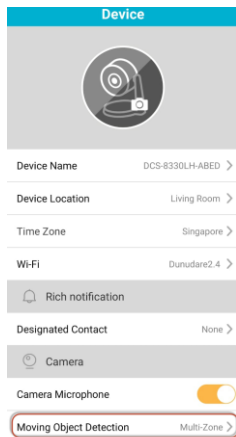

Step 9: Click on Boundary-Crossing Detection.

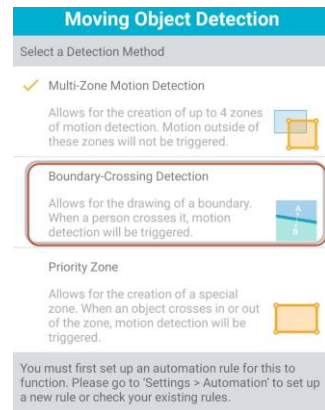

Step 10: a) Drop a line on the live view streams to select crossing zones.

b) select a triggered direction rule for detection for this camera.

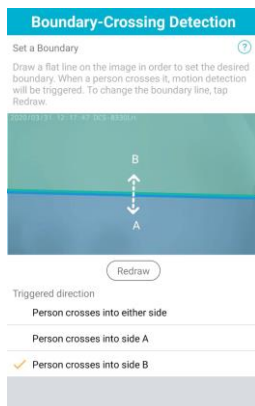

Step 11: a) Press Back on your mobile device for 5 Time and go back to the main page

b) Click on the Menu Icon.
c) Click on Settings.

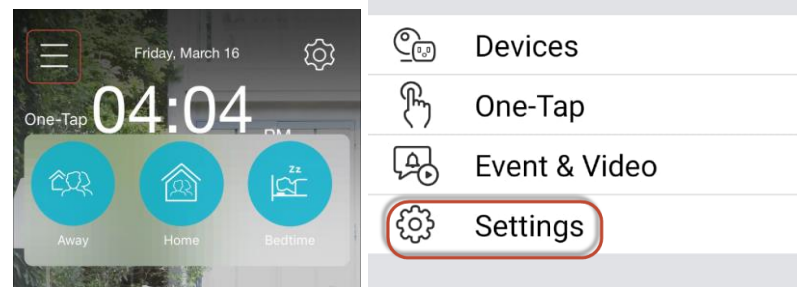

Step 12: Click on Automation icon.

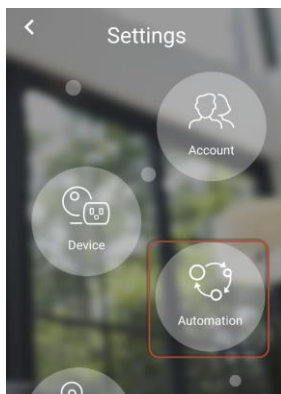

Step 13: Click on the Add Icon,

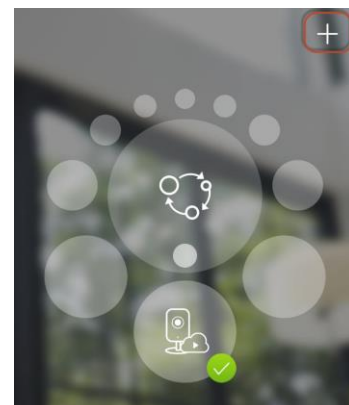

Step 14: Click on **Add** icon.

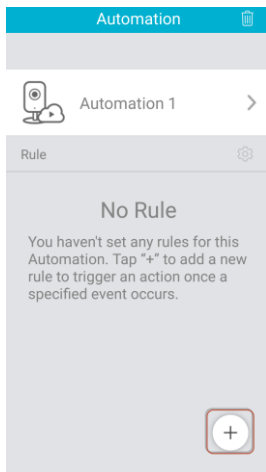

Step 15: a) Select **DCS-8330LH** with a **Motion Detection** icon.
b) Click on **Next**.

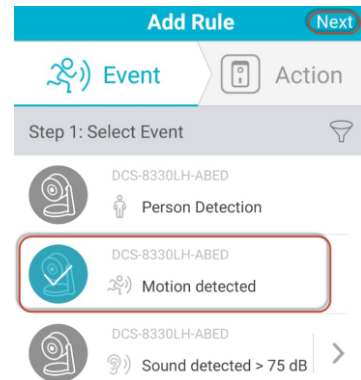

Step 16: a) Select **DCS-8330LH** with **Video Recording** Icon.
b) Click on **Next**.

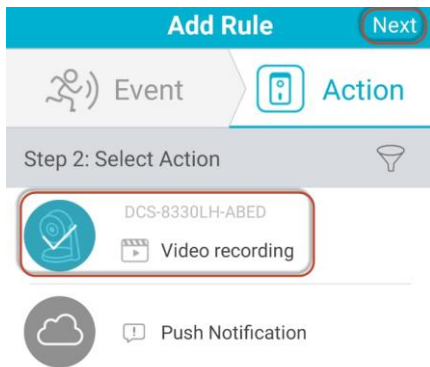

Step 17: Click on **Save**.

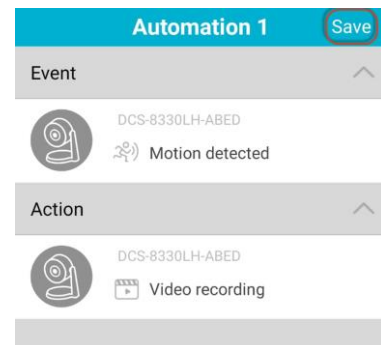

--- END ---